

PS 06

3-chamber PowerSpray® universal cleaning system for sizes up to 800 x 750 mm, 31,5" x 29,5". Cleans screen- PumpPrint stencils, PCB's, misprints, solder-frames and carriers, machine parts, squeegees from SMD-adhesive, SMD-solder paste, flux, flux condensati-on, oil, dust, grease and lots more.

Part no. 090506-PS-GB

One system for all cleaning jobs.



The situation:

Especially when fine pitch components are used, reproducible quality can only be achieved with clean screens/stencils or other above mentioned items. The still very common method of hand cleaning does not achieve high quality cleaning results. Furthermore it is accomplished with fumes and solvents* that are dangerous to the health. The **kolb PS 06** cleaning system works with waterbased cleaning fluids which do not contain solvents* and do not cause any irritating smells. Therefore the system does not require an extra safety area or any further safety precautions.

The advantages of the PS 06:

- high cleaning efficiency with short cleaning cycles: < 4-10 minutes.
- multistage filtering system within the cleaning circuit.
- efficient cleaning of pump print screens/stencils (with option XPower).
- efficient flux cleaning flux from PCB's (with option XPower).
- low maintenance required.
- no extra safety area, no special air ventilation necessary.
- can be installed in the production area.
- with optional chamber-heater to maintain PCB cleaning.
- noise < 69 dB (A).
- process chambers made of electrolysis resistant PVC .

The service and security features of the PS 06:

- cleaning cycle counter and hour meter.
- optional pH-monitor system for the rinse chamber.
- optional DI-monitor system for the rinse chamber.
- labyrinth lid seal system (no serviceable parts needed).
- complies with CE regulations.
- lockable emergency off switch.
- process safety shut down when system lid is opened.
- magnet connected pump system I422 with dry run protection.

The general maintenance features of the PS 06:

- cleaning fluid can be added to increase life span up to 1 year.
- change rinse water when pH-value is over 9 pH.
- with optional spray rinse system a rinse water change is not necessary.
- fine filter pressure gauge (indicates when fine filter change is necessary).
- **System must only be operated with certified cleaning fluids!!**

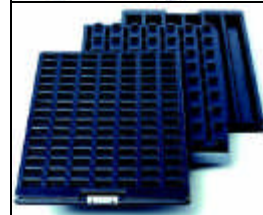
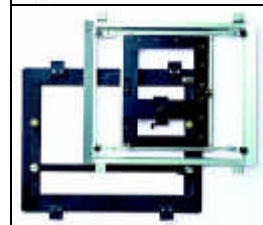
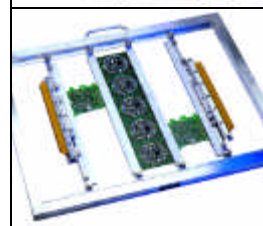
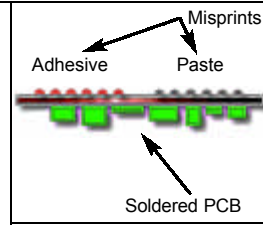

Applications

W. Kolb Fertigungstechnik GmbH
 Karl-Arnold-Str.12 · D - 47877 Willich
 For further information: www.kolb-ct.com

tel +49 (0) 2154 9479 - 38
 fax +49 (0) 2154 9479 - 47
 e-mail info@kolb-ct.com

*Solvent = organic hydrocarbon, under normal conditions volatile, flammable and risk of explosion.

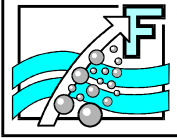

PS 06 3-Chamber PowerSpray®-System

Cleaning

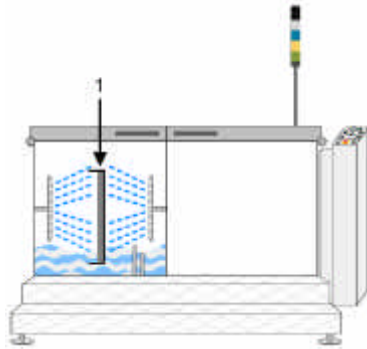

Rinsing

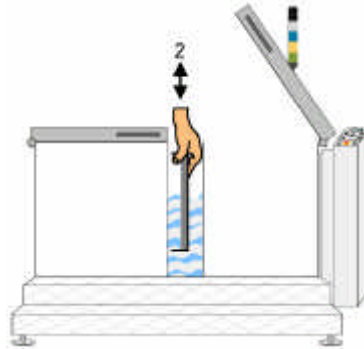

Drying

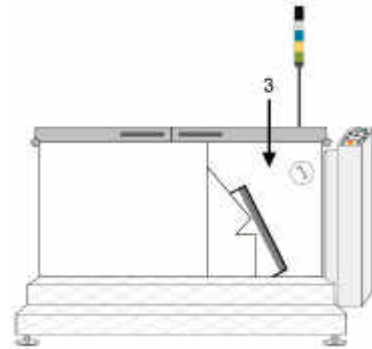

The **kolb** PS 06 is a 3-chamber universal cleaning system which enables short cycle times. The PS 06 is therefore capable within a short time of parallel process cleaning, rinsing and drying. Short cycle times enable quick reuse of production tools which together with the capability of placing the system in the production area is the best argument for a quick return on investment.

The cleaning cycle in the PS 06 takes according to size and type of contaminated parts approx. 4 - 10 minutes. The cleaning and rinsing processes can run simultaneously.

Cleaning: A fixture in the system holds the good to be cleaned in an optimum position during short cleaning process with PowerSpray technology at ambient temperature.

Rinsing: After cleaning the parts are either submerged into the rinse chamber or spray rinsed with normal tap water to remove all cleaning fluid residues.

Drying: The cleaned parts are placed into the drying chamber which is equipped with a TopSpeed dryer system (ambient air) or an optional HotSpeed system (heated air).

Technical data:

Mains power supply	:	400* V AC, 16 A (CEE plug); 50 to 60 Hz
Power dissipation	:	approx. 2,3 / 8,3* kW - * with option HotSpeed
Ambient temperature (min.)	:	approx. +20° Celsius
Noise	:	< 69 dB (A)
Compressed air connection	:	approx. 8 bar / litre consumption according to option
Weight	:	approx.. 350 kg (empty)
Cleaning chamber capacity	:	75 l (cleaning fluid mixture)
Rinse chamber capacity	:	110 l (tap water)
Max. solder- frame / stencil size	:	800 mm x 750 mm
Water inlet	:	metal 3/8" detachable (hose stem Ø 14 mm)
Outlet rinse chamber	:	metal 3/4", detachable (hose stem Ø 27 mm)
Outlet drying chamber	:	metal 3/8", detachable (hose stem Ø 14 mm)
Overflow connection	:	PVC Ø HT 50 mm, detachable
Dimensions of cleaning chamber	:	width 80-300 mm, depth 755 mm, height 800 mm
Dimensions of rinse chamber	:	width 140-180 mm, depth 800 mm, height 800 mm
Dimensions of drying chamber	:	width 70/50 mm, depth 800 mm, height 800 mm
System dimensions	:	width 1915 mm, depth 1665 mm, height (lid opened) 2150 mm incl. signal tower 2150 mm

W. Kolb Fertigungstechnik GmbH
Karl-Arnold-Str.12 · D - 47877 Willich
For further information: www.kolb-ct.com

tel +49 (0) 2154 9479 - 38
fax +49 (0) 2154 9479 - 47
e-mail info@kolb-ct.com